

# WALLUMS

WALL DECOR

## USEFUL ITEMS TO HAVE ON HAND



## INSPECTING YOUR DECAL



When you first receive your package, you will want to unroll the decal and inspect it. It is okay if there are any minor folds or creases from shipment - because the vinyl is pliable, any folds will not be visible once installed. If there are any tears or punctures, please take a picture of both the damaged decal and the shipping box, and contact us for a replacement. Some decals may come with multiple pieces which may need to be cut apart. **It is recommended you mock-up your design by laying it out on the floor or taping to the wall to see how all the pieces come together.**

## TESTING YOUR WALLS



You will notice your decal came with an installation kit including some test decals and a squeegee (*printed repositionable fabric decals do not come with a test decal or squeegee as they are just peel and stick*). The test decal is not just for practice! We highly recommend installing the test decal prior to installing your main decal and let it sit overnight.

Before applying your test decal, please be sure your wall is clean. We recommend using the 3m Enhanced Adhesion Cleaning Method ([www.wallums.com/wallprep.pdf](http://www.wallums.com/wallprep.pdf)). Please be sure to test this cleaning method in a small inconspicuous spot on your wall. Wallums cannot be held liable for any damage done to your walls during the cleaning or installation process.

Due to the many variables associated with your walls, you will want the test decal to sit at least 24-48 hours to assure the vinyl will adhere to your wall. If your paint is incompatible, shortly after installing the test decal, the edges will begin to peel up. If you notice this and did not utilize the 3m Enhanced Adhesion Cleaning Method above, we recommend you try again after completing the cleaning process.



WATCH OUR VIDEO INSTALLATIONS : <https://vimeo.com/wallums>

WEB: [wallums.com](http://wallums.com) — EMAIL: [info@wallums.com](mailto:info@wallums.com) — FACEBOOK: [facebook.com/wallumswalldecals](https://facebook.com/wallumswalldecals)

**PLEASE READ THESE INSTRUCTIONS THOROUGHLY BEFORE ATTEMPTING YOUR INSTALLATION.**

Wallums wall decals can be applied to any smooth surface such as walls, glass, metal, wood, mirrors, etc.

*Please Note:* Etched Glass is not recommended for wall use, only for application to glass or mirrors.

Because our decals are removable, children can pull them off - please install them out of reach of small reaching hands.

## INSTALLING YOUR DIE-CUT WALL DECAL

**BEFORE YOU BEGIN, INSTALL YOUR FREE TEST DECAL AND WAIT 24-48 HOURS TO BE SURE YOUR WALL DECAL WILL FULLY ADHERE TO THE WALL.**

There are multiple ways to install your decal, the example shown here is called a center hinge method; you may also use the top hinge or side hinge method. We highly suggest you watch our video instructions - visit [wallums.com](http://wallums.com) and click on the "Install Instructions" link in the main menu. If you are installing a design with large pieces, we recommend having a friend to help.

**1** Before applying, make sure the surface is dry and free of dust and dirt, this will help ensure your decal won't peel off on its own over time. Lay the decal on a flat surface. Use the squeegee provided and rub firmly across the front and back surfaces of the graphic to remove any bubbles and to strengthen the bond between the transfer tape and the decal. *Some designs may need to be cut apart prior to installing.*



**2** Position your decal on the wall with tape. If your decal came in multiple pieces, we suggest starting with the largest piece first. When trying to level your decal, be sure to line it up using the actual decal design and not the backing paper to ensure it's straight. When you're happy with the placement, proceed by taping the decal across the middle with a long strip of painter's tape.

**3** *Slowly* peel back one side of the transfer paper from the backing paper. If the decal doesn't come up with the transfer tape, go over it again with the squeegee or your finger and try again. While holding the transfer paper with the design portion gently folded back, use your scissors to cut away the blank backing paper that is revealed.

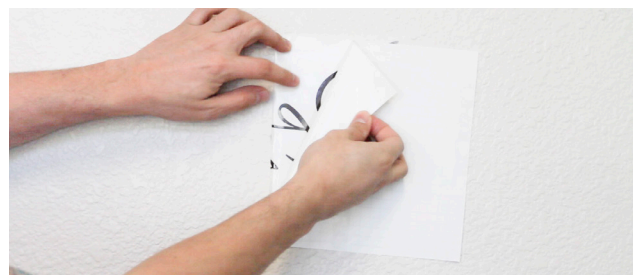
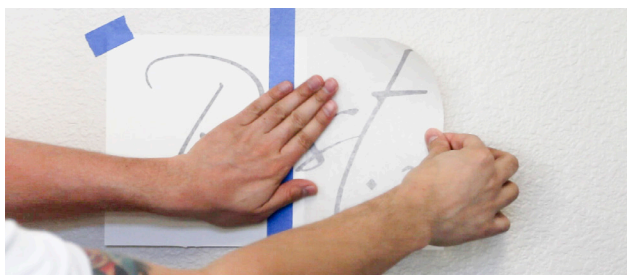

**4** Hold the bare half of the decal a few inches above the wall with slight tension to prevent the decal from touching. Use your hand or squeegee to smooth the decal onto the wall starting from the center where the hinge tape is and working your way out.

**5** Remove the remaining painter's tape. Carefully fold over the other half, slowly remove the rest of the white backing paper and press the rest of the decal to the wall.



**6** Use the squeegee to firmly rub across the entire vinyl graphic. Using a damp towel, get the surface of the transfer paper moist. This will help release it from the decal.



**7** Starting with one corner and working diagonally, slowly pull the transfer paper from the surface of the wall and decal. Pull slowly at a 180 angle and if needed, use your finger to push the revealed decal pieces against the wall.

**8** Double check to make sure all of the decal has adhered to the wall; use the backing paper as a barrier and go over the decal with a squeegee. If needed, you can quickly go over the decal with a hair dryer to work out any air bubbles. Be sure not to leave the hair dryer in one place for too long or you could damage your decal.

If your decal came in one solid piece, you're done! If your decal came in multiple pieces with square registration marks, please continue on to step 9. If your decal has other pieces without the registration marks, simply repeat steps 2-7.



**9** On some designs, we've added square registration marks to help you line up your other decal pieces. *These extra pieces also often have a slight overlap in the design to help hide any errors from misalignment.* Cut the extra paper away from the decal where the square marks are; this will make it easier to see in the next step.

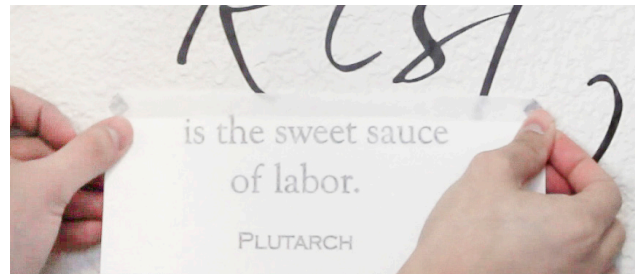

**10** Fold back a small part of the backing tape and line up the small square registrations on top of the set already on the wall. After you think the squares are perfectly overlapping, press that section down and use tape to keep the decal in place.

**11** Repeat the center hinge method in steps 2-7 or use a top hinge as shown below. If the piece is large, use more tape along the top to help keep it secured to the wall while you apply.



## UNMASKED VINYL PARTS

Some of our designs do not come with masking paper applied. This mostly applies to leaves of our large trees. We do not mask certain shapes to help speed up installation. Just peel and stick the unmasked shapes! TIP: Instead of trying to pick up a corner of the leaf with your fingernail, try turning the sheet over and bending the sheet to release/peel the leaf from the backing paper. This will help prevent your nail from damaging the shape.



## PRINTED WALL FABRIC DECALS + REMOVABLE WALLPAPER

Our printed wall fabric decals are simple to install. The instructions for die cut decals do not apply to wall fabric decals. Just carefully peel and stick! The wall fabric decals can be repositioned many times. You can even save the backing paper and apply the decal back to the backing paper for storage while you are moving to a new home. Use your backing paper as a barrier if using the provided squeegee. We recommend having a friend help for installing larger sized decals. If you plan on trying to move the decal in the future, we recommend saving the backing paper to transport the decals safely to your new location.



## REMOVAL OF DIE-CUT DECALS

Our die-cut decals are removable, but cannot be reused. When the time comes for you to remove your wall decals, you can do this in one of two ways:

1. Use your fingernail and gently start peeling at a corner and pull the decal until full removal. Be sure this is done by peeling the decal back upon itself at a 180 degree angle and not a 90 degree angle - this will help prevent tearing. Peel slowly to prevent damaging the paint on your walls.
2. Get a piece of masking tape and apply the tape on top of the decal. Slowly peel up the tape and the decal pieces should pull up with it. There are different strengths of adhesive to some masking tapes; we recommend testing the masking tape on the wall in an inconspicuous spot prior to use.

